



State of Rhode Island
Department of Administration / Division of Purchases
One Capitol Hill, Providence, Rhode Island 02908-5855
Tel: (401) 574-8100 Fax: (401) 574-8387

ADDENDUM #3

RFP #7670815

TITLE: Design Build Services for East Bay Bike Path Bridge Replacement

SUBMISSION DEADLINE: Friday April 1, 2022 at 11:00 AM

Please see the attached.

Marisa DelFarno

Marisa DelFarno
Buyer II



STATE OF RHODE ISLAND
RIDOT Addendum Notification

RFP #7670815 – DESIGN BUILD SERVICES FOR EAST BAY BIKE PATH BRIDGE REPLACEMENT

(REQUEST FOR PROPOSALS)

ADDENDUM #3

SUBMISSION DUE DATE: April 1, 2022 at 11:00 am

Per issuance of ADDENDUM #3 the following revisions are noted:

1. RFP Part 1 Revised Section 2.2
2. RFP Part 2 Revised Section 3.13.9
3. Addition of TAC 387
4. BTC Plans Revision to abutment sheets 14 and 21
5. Mandatory Specs Removal of Item #202.9902 Wildlife Fencing and addition of Item #202.9903 Diamondback Terrapin Protection
6. Appendix B.12 Addition of Roadways.dwg file

APPROVED:

Lori Fisette
Acting Administrator, Project Management

23-22

DATE

DATE	BY	REVISION NO.	DESCRIPTION
11/14/23	RL	BRG-0337(02)	

NOTES:
1. DIMENSIONS SHOWN ARE SCHEMATIC. FINAL DIMENSIONS TO BE CONFIRMED BY THE DESIGN BUILD TEAM.

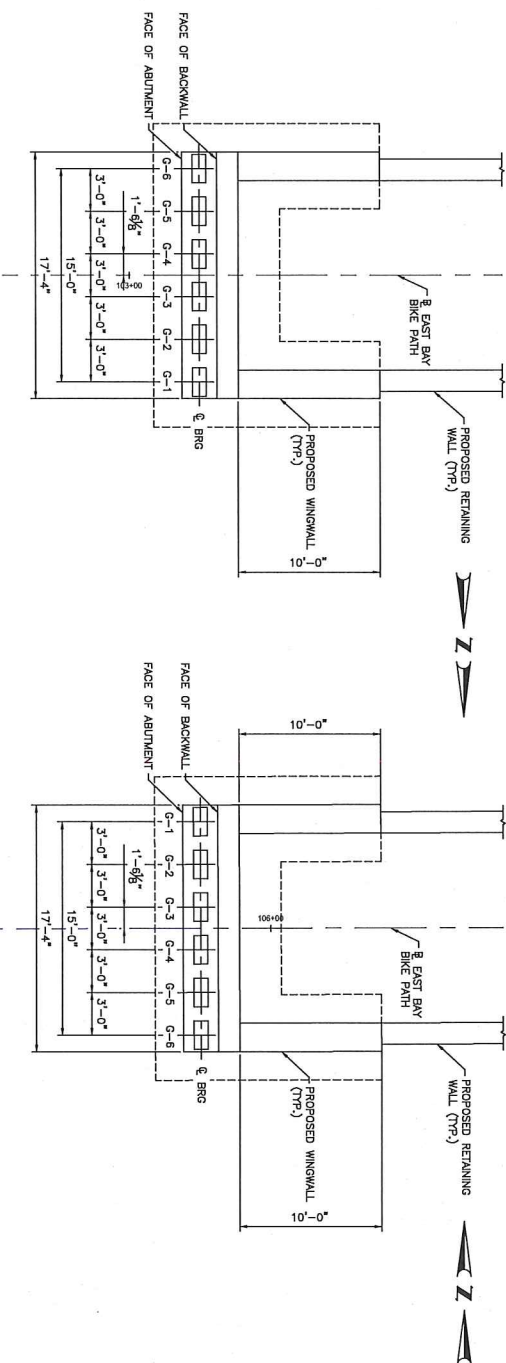

WEST ABUTMENT PLAN
SCALE X' = 1'-0"

EAST ABUTMENT PLAN
SCALE X' = 1'-0"

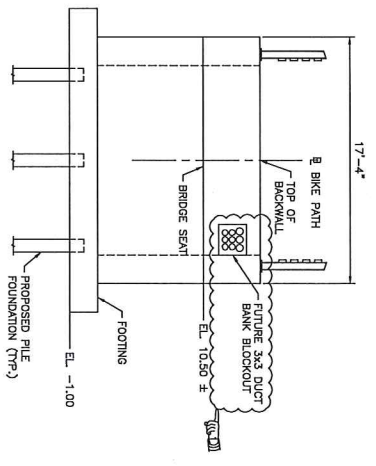

WEST ABUTMENT ELEVATION
SCALE X' = 1'-0"

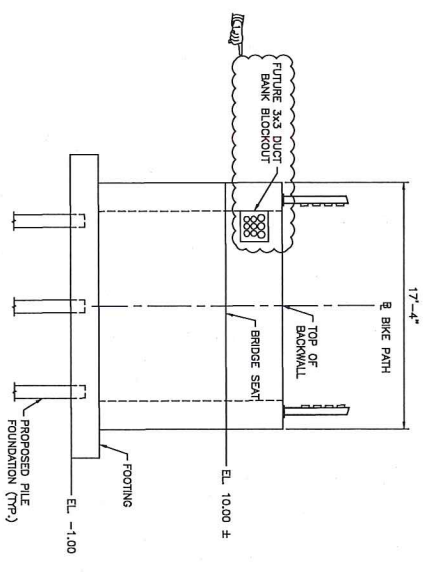

EAST ABUTMENT ELEVATION
SCALE X' = 1'-0"

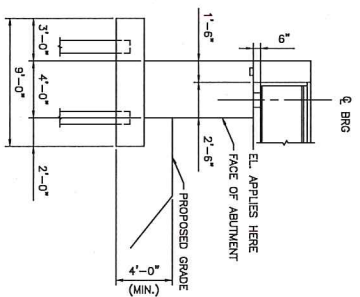

TYPICAL ABUTMENT SECTION
SCALE X' = 1'-0"

APPENDIX NO. 3

ARCHITECTURE
ENVIRONMENTAL
LAND SURVEYING

ARCHITECTURE
ENVIRONMENTAL
LAND SURVEYING

RHODE ISLAND
DEPARTMENT OF TRANSPORTATION

RDOT

BRIDGE NOS. 837 & 838 REPLACEMENT
ABUTMENTS

BRIDGE ISLAND

NO.	DATE	BY	NO.	DATE	BY
1	2/7/23				

SCALE AS NOTED

REV	DATE	BY	DESCRIPTION
1	01/13	SR	ISSUED FOR PERMIT

NOTES:
 1. DIMENSIONS SHOWN ARE SCHEMATIC. FINAL DIMENSIONS TO BE CONFIRMED BY THE DESIGN BUILD TEAM.

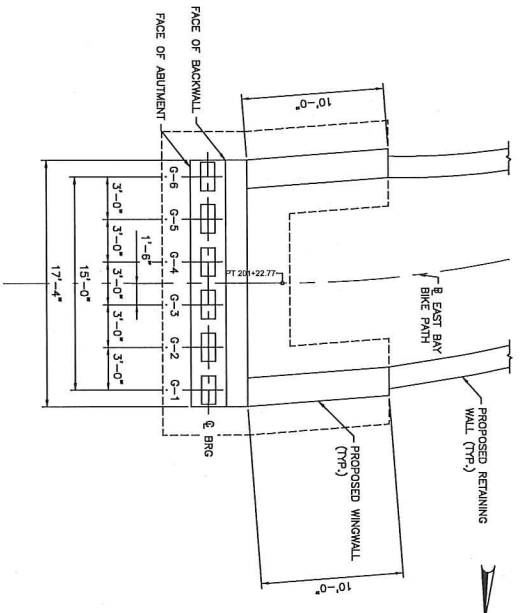

WEST ABUTMENT PLAN
 SCALE: X" = 1'-0"

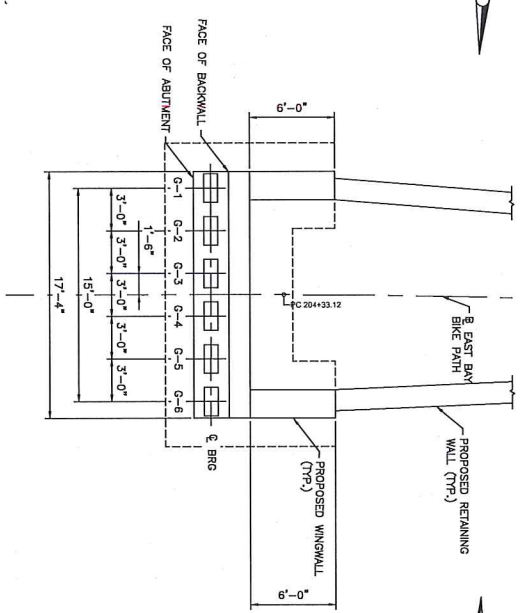

EAST ABUTMENT PLAN
 SCALE: X" = 1'-0"

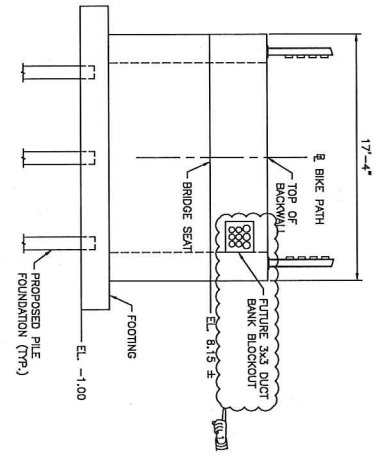

WEST ABUTMENT ELEVATION
 SCALE: X" = 1'-0"

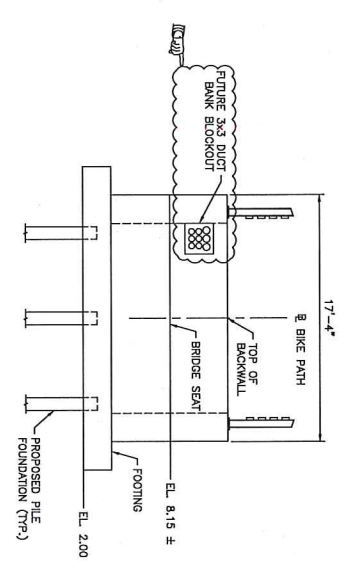

EAST ABUTMENT ELEVATION
 SCALE: X" = 1'-0"

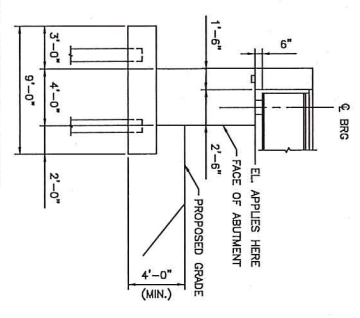

TYPICAL ABUTMENT SECTION
 SCALE: X" = 1'-0"

APPENDIX NO. 3

ARCHITECTURE
 ENVIRONMENTAL
 LAND SURVEYING

COMPANIES

RHODE ISLAND
 DEPARTMENT OF TRANSPORTATION

PROPOSED BY: SR
 CHECKED BY: SR
 DATE: DECEMBER 2011
 SHEET 21
 OF 25

SCALE AS NOTED

REVISIONS		REVISIONS	
NO.	DATE	BY	DATE
1	3/27/21	SR	

EAST BAY BIKE PATH
 BRIDGE NOS. 837 & 838 REPLACEMENT
 BRIDGE 0838851

ABUTMENTS

RHODE ISLAND



Department of Transportation
Two Capitol Hill
Providence, RI 02903

Office 401-222-2450
Fax 401-222-3905

To: All Consultants

TAC – 0387

Date: January 24, 2021

Subject: RIDOT and Army Corps of Engineers RI Programmatic General Permit Application Checklist

Consultants are hereby notified that the Rhode Island Department of Transportation (RIDOT) Natural Resources Unit (NRU) has developed a permit application checklist for submissions to the Army Corps of Engineers (USACE) under the USACE RI Programmatic General Permit (RIPGP).

If a USACE RI PGP is required, after submitting permit applications to the RI Department of Environmental Management (RIDEM) or the RI Coastal Resources Management Council (RICRMC), the permit application checklist will be completed and sent with a link to all the related documents required in the checklist to the RIDOT Natural Resources Unit and the Project Manager by email. The subject field should contain the PTSID. RIDOT NRU will review the submittal for completeness, track the RIDEM or CRMC permit ID once it is assigned by the State agency, and associate it with the correct project. The RIDOT NRU will then send the complete application package to the USACE for approval under the RIPGP.

Clarifications or questions regarding this document may be directed to the Natural Resources Unit. Thank you for your cooperation with this matter.

Sincerely,

Robert Rocchio

Robert Rocchio, P.E.
Chief Engineer



**RIDOT AND ARMY CORPS OF ENGINEERS RI PROGRAMMATIC GENERAL PERMIT
APPLICATION CHECKLIST**

The Rhode Island Department of Transportation shall submit the following checklist with the completed materials to the RIDOT Natural Resources Unit (NRU) with "Army Corps RIPGP Application: [Project Title and PTSID]" in the subject line. The RIDOT NRU will submit the application package to the Army Corps for review. For those materials that do not apply, put N/A. Please provide the RIDEM or CRMC application file number if available.

- Draft Cover Letter to Army Corps
 - Army Corps RIPGP Type (RIPGP Appendix A) - Please state which general permit the project anticipates approval under.
 - Project Summary and Purpose
 - Summary of Impacts in Army Corps Jurisdiction – provide a brief summary of project activities that propose fill or discharge into wetlands or waterways under Army Corps jurisdiction and/or dredging.
 - Impact Summary Table (see below)

Permanent Federal Wetland Impact	Temporary Federal Wetland Impact	Permanent Waterway Impact (below OHW/MHW)	Temporary Waterway Impact (below OHW/MHW)
acres/sq ft :	acres/sq ft:	acres/sq ft:	acres/sq ft:
material type (example - clean fill, parent material, etc):	material type (example- swamp mats, etc):	material type (example- rip rap, stream bed material, etc):	material type (example- Sand bag cofferdams, straw bales, etc.):

RI Department of Environmental Management (RIDEM) Office of Water Resources (OWR) Application Materials

Coastal Resources Management Council (CRMC) Freshwater Wetlands in the Vicinity of the Coast Application Materials and/or Coastal Resources Management Council (CRMC) Assent Application Materials

RIDEM/CRMC Permit Letter (if applicable) - If the project has been approved by the RIDEM or CRMC, please provide the permit letter along with the RIDEM/CRMC application materials.

RIDOT Road-Stream Crossing Design Manual Submittal Package
(https://www.dot.ri.gov/business/documents/Road_Stream_Crossing_Design_Manual_8_2021.pdf)



Section 408 Authorization

NEPA Documentation - NEPA documentation and supporting materials will be required to show compliance with federal regulations.

Categorical Exclusion (CE) Project Narrative and Checklist

Environmental Assessment (EA)/Environmental Impact Statement (EIS)

Supporting NEPA Documentation

USFWS Endangered Species Act (ESA) Section 7 Consultation – This includes an effect determination made through the USFWS IPaC for the Northern long-eared bat, as well as effect determinations for additional listed species in the project are if applicable

National Marine Fisheries Service (NMFS) Essential Fish Habitat (EFH) Individual Consultation

NMFS EFH FHWA Programmatic

NMFS ESA Section 7 FHWA Programmatic

NMFS ESA Section 7 Individual Consultation

Wild & Scenic Rivers Coordination

Section 106

FEMA and HEC Analyses

US Coast Guard Coordination

202.9903 DIAMONDBACK TERRAPIN PROTECTION

DESCRIPTION. The Contractor is hereby notified that the Rhode Island State Endangered Species, the northern diamondback terrapin (*Malaclemys t. terrapin*), is present within the Project limits. This species is protected by State laws, which prohibit killing, harming, taking, or keeping them in your possession. Northern diamondback terrapins are the only species of turtle in North America that spends its life in brackish water (water that is less salty than sea water). They are most abundant in tidal estuaries and will also be found in salt marshes and tidal creeks. Northern diamondback terrapins nest on the sandy borders of these habitats from June to July. Northern diamondback terrapins hibernate during the winter submerged in salt marshes and the mud of tidal creeks, with hatchlings often overwintering in the uplands near their nest. They enter hibernation as early as November and emerge as early as April through the end of May depending on water temperature.

All construction activities taking place within the Project limits will need to be coordinated with the RIDOT Natural Resources Unit (NRU) through the Engineer and Environmental Manager. At least 10 days prior to the commencement of any physical construction activities, the Contractor shall, through the Environmental Manager, arrange for a qualified Environmental Inspector/Monitor (EM) or their authorized delegate, to meet on site and discuss proper protocol for maintaining environmental commitments made for the protection of this species and habitat. NRU will provide oversight through the Environmental Manager and the EM to ensure that the following protocols are followed and maintained during the course of the Project.

MATERIALS. All materials shall be in accordance with the applicable sections of the RIDOT Standard Specifications for Road and Bridge Construction, Amended 2018, with all revisions, unless otherwise specified below.

Temporary wildlife fencing: The temporary wildlife fencing shall be installed to protect, exclude, and guide the terrapins within the work area. The selected fence shall be appropriate for small turtles. The Contractor shall inform RIDOT NRU and the Environmental Monitor when installing the temporary wildlife fencing.

Temporary wildlife fencing shall conform to Subsection 206.02.2 – Silt Fence or shall be the following or an approved equal:

Animex
AMX-40
5616 Geary Blvd., Suite 211
San Francisco, CA 94121
1-406-371-2770
usa@animexfencing.com
www.animexfencing.com

CONSTRUCTION METHODS. The work covered under this Job Specific Provision includes the provision of services related to the protection of terrapins in the work area. In addition to the requirements stated on the Plans and elsewhere in the Contract Documents, the Contractor shall be responsible for the following:

1. The Contractor shall work with the Environmental Manager to retain the services of a qualified EM to provide services as outlined herein. The EM shall have a minimum of 5 years of experience performing investigations and monitoring of terrapins in New England. Prior to beginning the work, the Contractor shall submit qualifications demonstrating the Consultant's experience for approval by the RIDOT Environmental Division. Qualifications shall include the Consultant's resumé, a list of related projects performed, and sample reports and articles from at least two projects. The EM shall provide the following services:

Educate the Contractor and Subcontractors working on site about the presence of the northern diamondback terrapin and actions to be taken should one or more be observed within the project area. Information shall be presented at a meeting to be attended by all the Contractor's and Subcontractor's employees and the Resident Engineer. It is anticipated that presentation of the information will take up to 30 minutes followed by a question-and-answer period. It is further anticipated that this presentation will be conducted once prior to the start of any work on the site and once at the start of each construction season.

b. Prepare printed materials for distribution to all workers. The materials should contain photos and should summarize critical information related to terrapin identification and what to do in the event one is found in the work area. The material should also contain contact information. It is estimated that review of printed materials will require approximately 10 minutes for an individual worker.

c. Prepare laminated signs in the work area and in the site trailer and/or field office reminding workers of the information in the printed material.

2. Contractor and Subcontractor staff are to report sightings of terrapins in or near the work area to the Resident Engineer and the EM, who will report the sightings of terrapin to the Environmental Manager and the RIDOT NRU. Actions and precautions should be taken should one or more terrapins be observed in or near the work area. The Contractor shall post laminated signs in the work area and in the site trailer and/or field office reminding workers of this information.

a. The Contractor must search the work area each morning for the presence of this listed species prior to any work being done. Binoculars should be used from the shore and/or boats to look for turtle heads emerging from the surface of the water.

b. If any northern diamondback terrapins are encountered in water within the immediate work area, the Resident Engineer shall be immediately informed to contact the EM and the RIDOT NRU, and in-water work shall stop until the terrapin are outside of the project limits and work can resume after approval from the EM.

c. Any northern diamondback terrapins encountered upland within the immediate work area shall be carefully moved to an in-water location outside of the project limits and the Resident Engineer shall be immediately informed to contact the EM and the RIDOT NRU with the location.

d. Prior to construction, the Contractor shall inspect the channel below the bridges for nets, fishing gear, or any other materials that have the potential to snag terrapins. The Contractor shall remove all potential snags and dispose of properly.

- e. During construction, the Contractor shall not utilize or allow any equipment within the water or hanging over the sides of vessels that have the potential to snag terrapins. Additionally, all outside surfaces of sheet piles shall be maintained free from fabric or netting that might ensnare terrapins in any season.

3. RIDOT will require the following precautionary measures to protect the terrapin and terrapin habitat during construction:

- a. During the terrapin's dormant period (November 1 to April 1), the areas within the project limits must be inspected for any nest sites by the EM before construction activities will be allowed in upland areas. If nests are found, nests will not be disturbed and the RIDOT NRU will be contacted immediately.
- b. All staging and storage areas in the vicinity of Northern diamondback terrapin habitat, outside of previously paved locations, regardless of the duration of time they will be used, must be reviewed by, and receive written approval from NRU through the Resident Engineer.
- c. No heavy machinery or vehicles may be parked in any identified Northern diamondback terrapin habitat.
- d. Exclusionary practices, such as fencing, will be required in order to prevent any Northern diamondback terrapin access to construction areas. These measures will need to be installed at the limits of disturbance as shown on the plans.
- e. Exclusionary fencing shall be at least 20 inches tall and must be secured to and remain in contact with the ground. The Contractor shall regularly inspect and maintain the fencing to prevent any gaps or openings at ground level. Standard silt fence is adequate; fencing with netting shall not be used.
- f. Exclusionary fencing shall be removed when it is no longer needed, and silt fence shall be removed as soon as the area is stable, to allow for reptile and amphibian passage to resume.

4. For any in-water work done during the terrapin's active period, which includes the nesting and hatching period, (April 1 to October 31), RIDOT will require the following precautionary measures:

- a. The Contractor must use special caution when navigating within tidal creeks. Terrapins tend to congregate close to the surface during their active period. Maintaining slow speeds will ensure the turtles' safety. Using binoculars from shore or from a work vessel will improve the ability to detect terrapins in the water.
- b. The Contractor shall notify the EM a minimum of 48 hours prior to the initiation of any dewatering activity. No dewatering shall take place without the EM present. The Contractor shall provide the EM with access to the interior of all cofferdams if used and will permit the EM to inspect the area for the presence of terrapins prior to any work occurring within or material being placed into the cofferdam.

c. Immediately at the completion of any dewatering operations, any dewatered area that is typically in 3 feet of water at low tide or greater shall be inspected for the presence of terrapins. If any terrapins or eggs are found RIDOT NRU will be notified immediately, and the terrapin or eggs shall be relocated by the EM upon RIDOT NRU approval.

METHOD OF MEASUREMENT. This item will not be measured for payment.

BASIS OF PAYMENT: For this project, the costs for the work required by this specification will be compensated as part of the D-B Price. The Contractor shall specify, in the schedule of values, the amount of the Lump Sum price allocated for the performance of this item.

APPENDIX A

Northern Diamondback Terrapin Information Sheet

01-06-22



Northern Diamondback Terrapin Rhode Island State Endangered Species

Scientific Name: *Malaclemys t. terrapin*

Size: Males: 4-5.5 inches (10.2-14 cm) in length

Females: 6-9 inches (15.2-22.9 cm) in length

Habitat Type:

The Northern diamondback terrapin is the only species of turtle in North America, including Rhode Island, that spends its life in brackish water (water that is less salty than sea water) which includes salt marshes, estuaries, and tidal creeks. Terrapins overwinter in the mud of tidal creeks and in salt marshes, with hatchlings often overwintering in the uplands near their nest. If a safety boat or barge is to be used, be aware of turtles possibly mating within the project area and proceed slowly when in tidal areas. Nests are constructed on the sandy borders of salt marshes and in dunes.

Colorations (see Appendix A):

- The terrapin has both a dark and light variation. Both variations have carapaces (top of shell) patterned with concentric rings or ridges.
 - The dark variant has a completely black carapace with a yellow to off-white plastron (bottom chest plate). Their heads are gray to off-white with small black spots or streaks and their legs are dark gray to black.
 - The lighter variant has a gray to light brown carapace with yellow to greenish gray plastrons. Their heads are gray with small pepper-like gray spots and their legs are gray.
- The plastron may or may not be marked with bold, dark markings.
- The limbs and head may be spotted.
- Hatchlings are patterned similar to adults but are brighter.

Characteristics (see Appendix A):

- Small marine turtle. They spend their entire lives in a brackish environment.
- The carapace is wedge-shaped when viewed from above, with the widest part in the rear. They have raised ridges alongside the upper shell that runs from front to the back.
- They have large, webbed feet.
- They are most often found in the water column with the head above the water. They are often seen with the head rising above the water's surface for a brief time before resubmerging under water.

If any Northern diamondback terrapins are observed in or around the project area, the RIDOT Natural Resources Unit (NRU) must be notified at 401-734-4892 and dot.nru@dot.ri.gov.

Appendix A. Photo Identification



APPENDIX B

Animex® Specifications

AMX40

Temporary & Permanent Wildlife Fencing

Specification & Installation Guides
SUMMER 2021

SUITABLE SPECIES

- SALAMANDERS
- NEWTS
- TOADS
- TORTOISES
- SNAKES
- TURTLES
- LIZARDS
- SMALL MAMMALS

Contents

Basic Material Size & Features pg.1

Step by Step Installation pg.3

Fixing & Fastening pg.6

Free-standing pg.10

Attached pg.14

Specialized pg.24

Tender Document Descriptions pg.28

Animex[®]

www.animexfencing.com

© Copyright Animex International 2021

AMX 40
 Basic Material Size & Features

AMX 40
 Basic Material Size & Features

The length of each AMX 40 section will vary depending on the material choice.
 AMX 40 dimensions based on Animex's optimal fencing materials.

SCORED PLASTIC - PERFORATED & NON-PERFORATED
Temporary Applications (AMX-T)
 Thickness: 0.04in / 1mm
 Length: 75ft / 22m
 Weight: 50lbs / 23kg

Semi-Permanent Applications (AMX-SP)
 Thickness: 0.08in / 2mm
 Length: 35ft / 10m
 Weight: 48lbs / 22kg

PERFORMED METAL- PERFORATED & NON-PERFORATED
Permanent Applications (AMX-XP)
 Thickness: 0.08in / 2mm
 Length: 8ft / 2.4m
 Weight: 85lbs / 38kg

AMX 40 INSTALLED ABOVE GROUND HEIGHT: 22in / 550mm

Notes:
 These dimensions are based on maximising the amount of material that can be shipped economically and manoeuvred on site in line with common health and safety guidelines.

Material may be shipped in sheets or rolls depending on their length.

Customised options for alternative AMX40 barrier options are available from Animex' Fencing suppliers upon request. Other traditional and existing fencing materials including posts and wire etc can be obtained from local contractors.

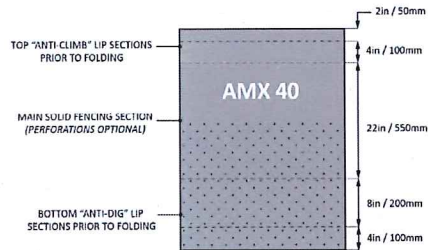

AMX 40
 Basic Material Size & Features

2 | COPYRIGHT ANIMEX - INTERNATIONAL 2021

Animex

Animex

SPECIFICATIONS & INSTALLATION GUIDES | 3

AMX 40
 Step-by-Step Installation

AMX 40
 Step-by-step Installation

- 1) Clear vegetation along the fence line and work area.
- 2) Mark out the Animex fence line.
- 3) **Below Ground:** Excavate trench. Ensure the trench is level and clear of large clumps or rocks.
Above Ground: Clear Ground. Ensure the ground is level and clear of large clumps or rocks.
- 4) **Free-Standing:** Lay out posts and roll out Animex barrier (Fold bottom lip if required).
Attached to existing fences: Roll out Animex barrier along fence (Fold bottom lip if required).
- 5) Install posts at the back of the trench using manual or machine powered post driver (Install horizontal wire if required and secure to end braces).
- 6) Place the Animex fence material into the trench with the lips facing towards the area that animals will encounter the fence.
- 7) Fasten the Animex to posts, straining wire or existing fence starting at the top and work down.
- 8) When attaching rolls overlap them following details on installation drawing Pg7. A minimum of 4 ties should be used on any joins in the fence
- 9) Back fill the trench. Ensure the backfill is compact to eliminate gaps for animals to crawl through. Do the same on the back side of the fence.
- 10) Fasten the top lips and install any additional features such as one-way funnels or pitfall traps (if required).

MATERIALS

- Required*
- Animex Fencing
 - Animex Washers
 - UV Resistant Zip-ties or Fencing Wire
 - Fence Posts

- Optional*
- 12 Gauge Straining Wire
 - Fence end braces & wire strainers
 - Gripple Wire Joiners (or similar)
 - Fence Post Safety Caps

TOOLS & EQUIPMENT

- Required*
- Weed wacker / Whipper
 - String Line & Marker Pail
 - Box Cutter / Stanley Knife
 - Trencher / Excavator
 - Spade / Trench / Shovel
 - Post Driver / Sledge Hammer
 - Battery Powered Drill
 - Spade Drill Bit 3/4 (20mm)
 - Cutting Pliers

- Optional*
- Shear Attachment For Drill (Trim Fence)
 - Battery Powered reciprocating Saw (Trim Posts)
 - Drill Bit For Drainage Holes 1/8in (3mm)
 - Gripple Tensioning Tool

AMX 40
 Step-by-step Installation

4 | COPYRIGHT ANIMEX - INTERNATIONAL 2021

Animex

Animex

SPECIFICATIONS & INSTALLATION GUIDES | 5

Fixings & Fastening
 Scored Plastic HDPE

AMX-T & AMX-SP

Pre-scored plastic (HDPE) sheets and rolls can expand in when installed in places where there are large fluctuations in temperature. You should therefore avoid hard fixing this material as it can cause buckling and even open up gaps at overlapped or joining sections.

We have prepared some illustrations to demonstrate the best ways to connect and fasten HDPE rolls and sheets.

This technique helps to reduce the chances of gaps opening up at the joins and allows the fencing to expand and contract freely.

Ensuring the trench is backfilled correctly and the earth is compacted tightly against both sides of the fence is also essential to ensure there are no gaps at ground level where animals will be encountering the fence.

Joins should be made between posts and onto horizontal wire or horizontal parts of existing fences where possible.

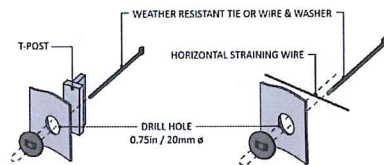

ATTACH TO POSTS
 NOT TO SCALE

ATTACH TO WIRE
 NOT TO SCALE

NOTES:
 This specification should be used for all installations. Measurements are accurate but may need to be adjusted dependent on local conditions, conditions and local authority requirements.

Fixings & Fastening
 Scored Plastic HDPE

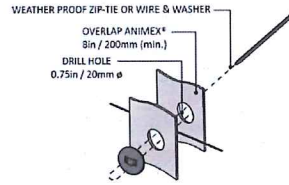

JOINING & OVERLAPPING SECTIONS
 NOT TO SCALE

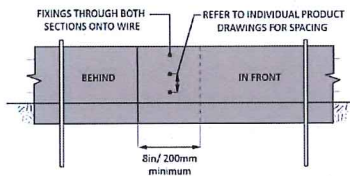
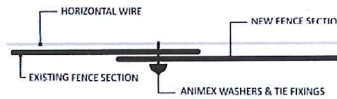

Fixings & Fastening
 Scored Plastic HDPE

© COPYRIGHT ANIMEX INTERNATIONAL 2021

Animex

Animex

SPECIFICATIONS & INSTALLATION GUIDES 17

Fixings & Fastening

Fixings & Fastening
 Preformed Metal

AMX-XP

Preformed metal fencing is supplied in sections that are often custom made for your project.

Each section slots inside the other and is then fastened by drilling holes through the overlapping sections and securing with bolts, nuts and washers.

End sections and turn-arounds will also be custom made per project and fitted on site.

Panels can be supplied with a power coating but this will increase costs and may need touch ups after installation.

NOTES:
 This specification should be used for all installations. Measurements are accurate but may need to be adjusted dependent on local conditions, conditions and local authority requirements.

Fixings & Fastening
 Scored Plastic HDPE

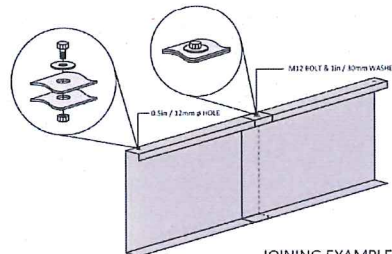
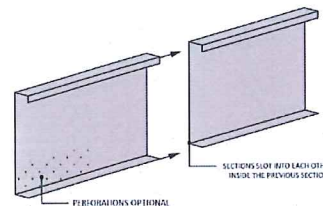

JOINING EXAMPLE
 NOT TO SCALE

Fixings & Fastening
 Scored Plastic HDPE

© COPYRIGHT ANIMEX INTERNATIONAL 2021

Animex

Animex

SPECIFICATIONS & INSTALLATION GUIDES 19

Fixings & Fastening

● **AMX 40**
 Free-standing Below Ground

NOTES:
 This specification should be used in all installations. Measurements are accurate but may need to be adjusted dependent on location, conditions and local authority recommendations.

AMX 40
 Free-standing Below Ground

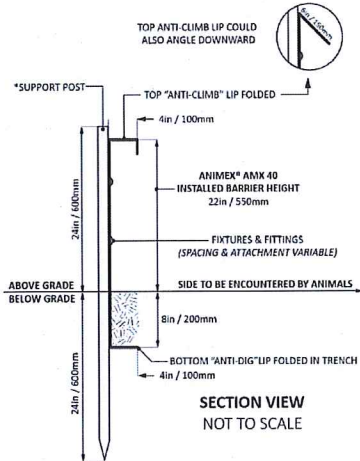

*SUPPORT POSTS & HORIZONTAL WIRE MAY NOT BE NEEDED FOR PREFORMED METAL (AMX-XP) FENCES
 **HORIZONTAL WIRE MAY NOT BE NEEDED FOR TEMPORARY (AMX-T) FENCES

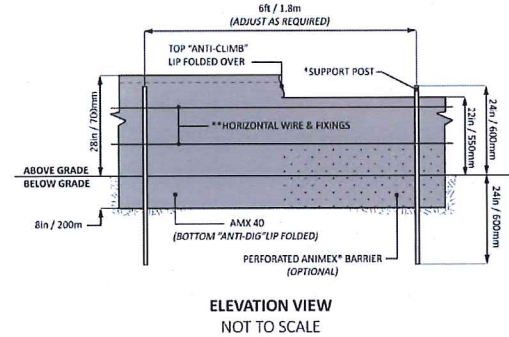

NOTES:
 This specification should be used in all installations. Measurements are accurate but may need to be adjusted dependent on location, conditions and local authority recommendations.

AMX 40
 Free-standing Below Ground

10 | COPYRIGHT ANIMEX INTERNATIONAL 2021

Animex

Animex

SPECIFICATIONS & INSTALLATION GUIDES | 11

● **AMX 40**
 Free-standing Above Ground

NOTES:
 This specification should be used in all installations. Measurements are accurate but may need to be adjusted dependent on location, conditions and local authority recommendations.

AMX 40
 Free-standing Above Ground

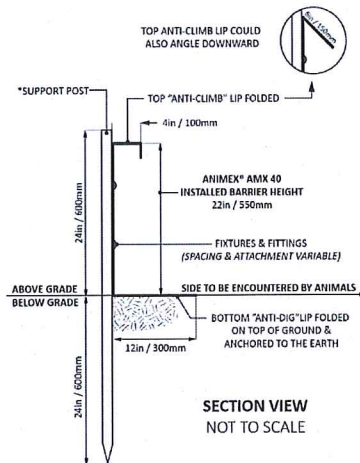

APPLY THIS ABOVE GROUND METHOD
 WHEN ATTACHING TO EXISTING
 FENCE TYPES AS WELL

*SUPPORT POSTS & HORIZONTAL WIRE MAY NOT BE NEEDED FOR PREFORMED METAL (AMX-XP) FENCES
 **HORIZONTAL WIRE MAY NOT BE NEEDED FOR TEMPORARY (AMX-T) FENCES

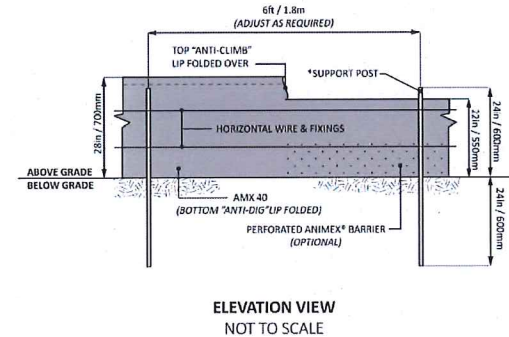

NOTES:
 This specification should be used in all installations. Measurements are accurate but may need to be adjusted dependent on location, conditions and local authority recommendations.

AMX 40
 Free-standing Above Ground

12 | COPYRIGHT ANIMEX INTERNATIONAL 2021

Animex

Animex

SPECIFICATIONS & INSTALLATION GUIDES | 13

AMX 40
 Attached Garrison

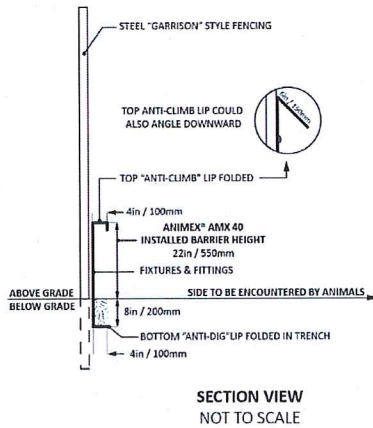

NOTES:
 This specification should be used for all installations. Measurements are accurate but may need to be adjusted dependent on location, conditions and local authority recommendations.

AMX 40
 Attached Garrison

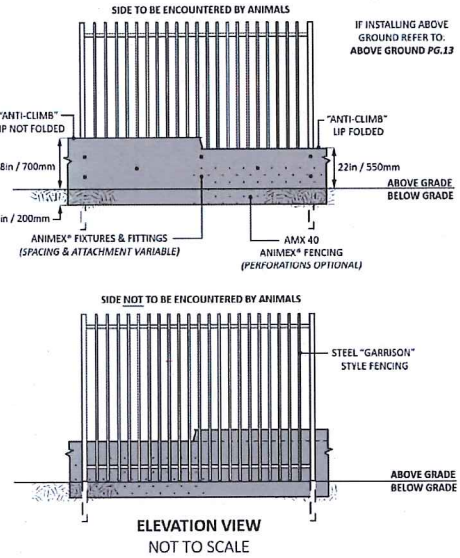

NOTES:
 This specification should be used for all installations. Measurements are accurate but may need to be adjusted dependent on location, conditions and local authority recommendations.

AMX 40
 Attached Garrison

14 | COPYRIGHT ANIMEX INTERNATIONAL 2021



SPECIFICATIONS & INSTALLATION GUIDES | 15

AMX 40
 Attached Chain-link

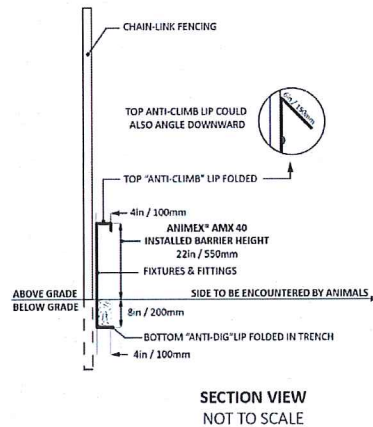

NOTES:
 This specification should be used for all installations. Measurements are accurate but may need to be adjusted dependent on location, conditions and local authority recommendations.

AMX 40
 Attached Chain-link

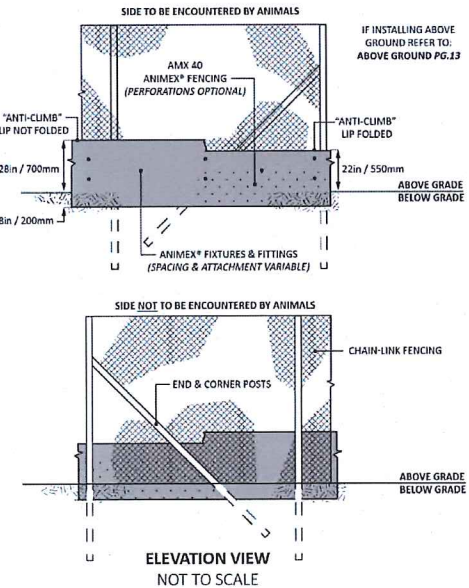

NOTES:
 This specification should be used for all installations. Measurements are accurate but may need to be adjusted dependent on location, conditions and local authority recommendations.

AMX 40
 Attached Chain-link

16 | COPYRIGHT ANIMEX INTERNATIONAL 2021



SPECIFICATIONS & INSTALLATION GUIDES | 17

AMX 40
 Attached Livestock

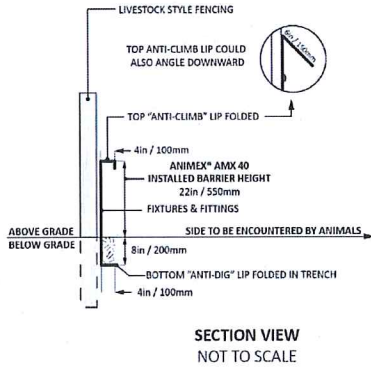

NOTES:
 This specification should be used to aid installation. Measurements are accurate but may need to be adjusted dependent on location, conditions and local authority recommendations.

AMX 40
 Attached Livestock

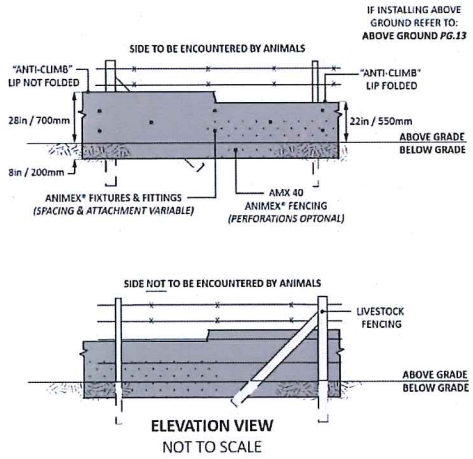

NOTES:
 This specification should be used to aid installation. Measurements are accurate but may need to be adjusted dependent on location, conditions and local authority recommendations.

AMX 40
 Attached Livestock

18 | COPYRIGHT ANIMEX INTERNATIONAL 2021

Animex — Animex

SPECIFICATIONS & INSTALLATION GUIDES | 19

AMX 40
 Attached Security

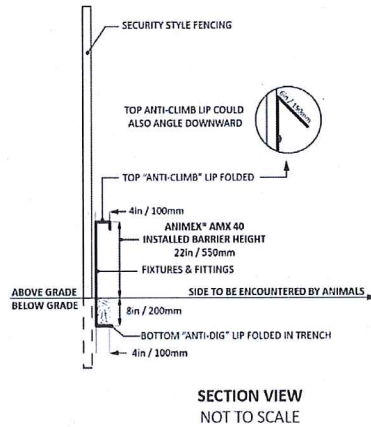

NOTES:
 This specification should be used to aid installation. Measurements are accurate but may need to be adjusted dependent on location, conditions and local authority recommendations.

AMX 40
 Attached Security

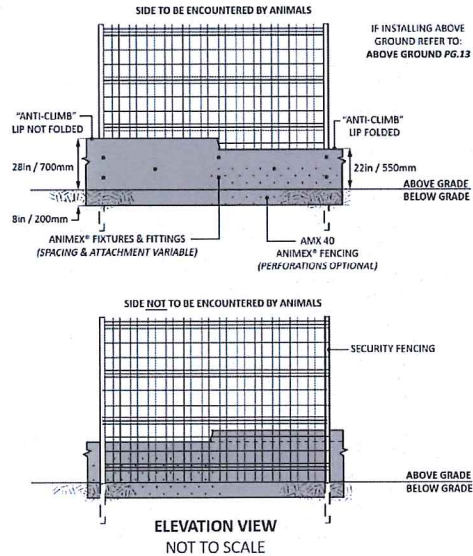

NOTES:
 This specification should be used to aid installation. Measurements are accurate but may need to be adjusted dependent on location, conditions and local authority recommendations.

AMX 40
 Attached Security

20 | COPYRIGHT ANIMEX INTERNATIONAL 2021

Animex — Animex

SPECIFICATIONS & INSTALLATION GUIDES | 21

AMX 40
 Attached Large Wildlife

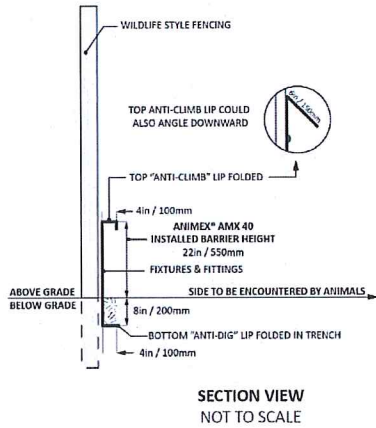

NOTES:
 This specification should be used to aid installation. Measurements are accurate but may need to be adjusted dependent on location, conditions and local authority recommendations.

AMX 40
 Attached Wildlife

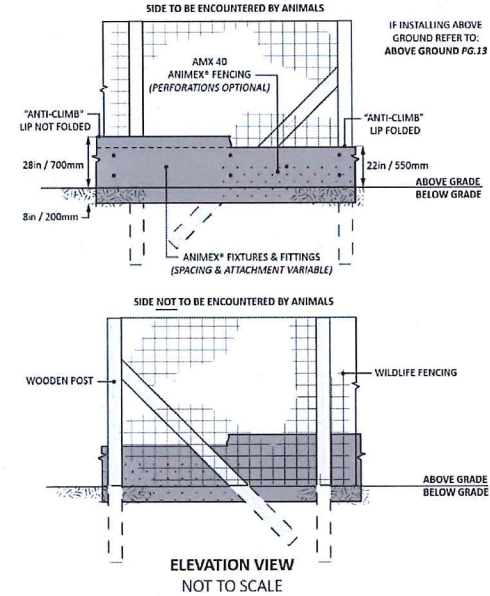

NOTES:
 This specification should be used to aid installation. Measurements are accurate but may need to be adjusted dependent on location, conditions and local authority recommendations.

AMX 40
 Attached Security

22 | COPYRIGHT ANIMEX INTERNATIONAL 2021

Animex

Animex

SPECIFICATIONS & INSTALLATION GUIDES | 23

Specialized Fencing Specifications
 Roadside Embankment

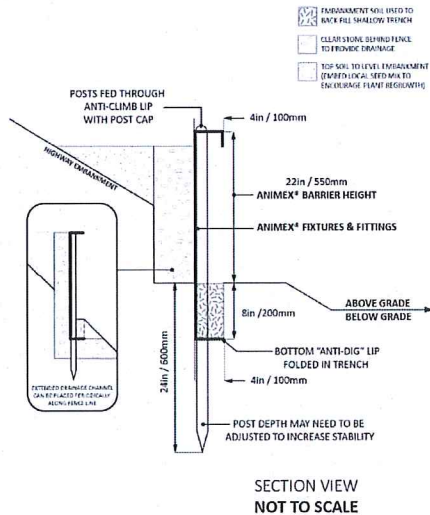

NOTES:
 This specification should be used to aid installation. Measurements are accurate but may need to be adjusted dependent on location, conditions and local authority recommendations.

Specialized Fencing Specifications
 Roadside Embankment

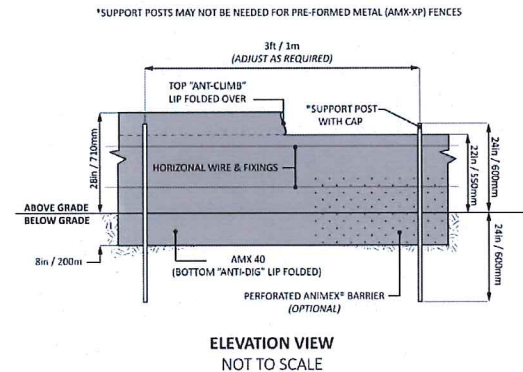

Specialized Fencing Specifications
 Roadside Embankment

24 | COPYRIGHT ANIMEX INTERNATIONAL 2021

Animex

Animex

SPECIFICATIONS & INSTALLATION GUIDES | 25

● **Specialized Fencing Specifications**
 Roadside Guardrail

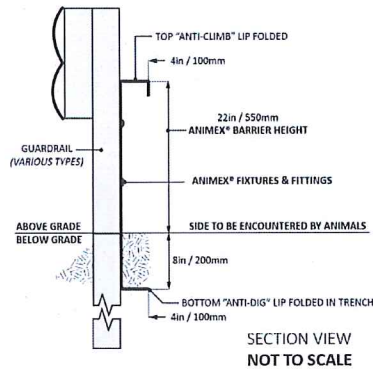

NOTES:
 This specification should be used to all installations. Make sure the contractor fully understands the adjustment requirements on location, conditions and local authority requirements.

Specialized Fencing Specifications
 Roadside Guardrail

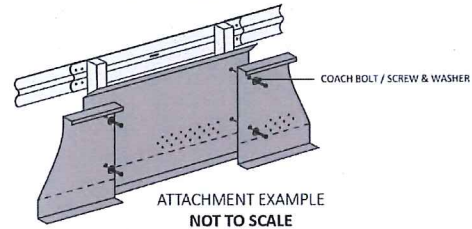
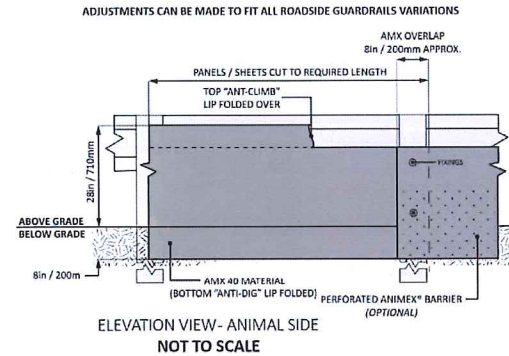

Specialized Fencing Specifications
 Roadside Guardrail

26 | COPYRIGHT ANIMEX INTERNATIONAL 2021

Animex

Animex

SPECIFICATIONS & INSTALLATION GUIDES | 27

Specialized Fencing Specifications

● **Tender Document Descriptions**

AMX 40
 Tender Document Descriptions

AMX-T / AMX-SP

General Description:
 Specifically designed solid Animex wildlife fencing barrier to protect, exclude or guide wildlife.

Common Applications:
 Roads
 Construction sites
 Scientific research
 Conservation zones
 Species re-introduction

Material Height:
 1015mm (40in)
 1070mm (42in)
 1220mm (48in)
 1550mm (60in)
 Custom options available

Material Thickness:
 AMX-T (Temporary): 1mm
 AMX-SP (Semi-Permanent): 2mm

Material Properties:
 Solid barrier - no mesh, matrix or geo-textile material
 Made from High Density Polyethylene (HDPE) in North America
 Grooves or scoreline 100mm (4in) from the top and bottom edge to create fold-able lips
 Glossy surface on one side
 Perforations to allow water flow (if required)
 Supplied in sheets or rolls
 Maximum weight per item 25kg (55lbs)

Installation:
 See relevant drawings and guides displayed in this document between pages 6 and 26

AMX-XP

General Description:
 Specifically designed solid Animex wildlife fencing barrier to protect, exclude or guide wildlife.

Common Applications:
 Roads
 Construction sites
 Scientific research
 Conservation zones
 Species re-introduction

Material Height:
 1015mm (40in)
 1070mm (42in)
 1220mm (48in)
 1550mm (60in)
 Custom options available

Material Thickness:
 AMX-XP - (Permanent): 2mm

Material Properties:
 Solid metal barrier - no mesh, matrix or geo-textile material
 Made from weather resistant metals
 Pre-formed with top and bottom lips (as detailed in drawing pg9)
 Perforations to allow water flow (if required)
 Supplied in sheets
 Maximum weight per item 40kg (88lbs)

Installation:
 See relevant drawings and guides displayed in this document on pages 8 and 9

AMX 40
 Tender Document Descriptions

28 | COPYRIGHT ANIMEX INTERNATIONAL 2021

Animex

Animex

SPECIFICATIONS & INSTALLATION GUIDES | 29

This document is continually updated based on new research and information.

To ensure you are referencing the most recent version please contact:
info@animexfencing.com

FOR MORE INFORMATION OF WILDLIFE FENCING PLEASE VISIT:

WWW.WILDLIFEFENCING.COM

Animex[®]
www.animexfencing.com

© Copyright Animex International 2021



EAST BAY BIKE PATH BARRINGTON/WARREN

BARRINGTON/WARREN, RHODE ISLAND

Bid # 7670815

BEST VALUE DESIGN-BUILD PROCUREMENT FOR
EAST BAY BIKE PATH
REQUEST FOR PROPOSALS

PART 1
INSTRUCTIONS TO PROPOSERS

ADDENDUM #3
February 3, 2022

proposed detour modifications and how it plans to minimize the resulting detour.

Also included in the scope of work will be the removal of the temporary path detour route and restoration of the existing bridges carrying Route 114. The bridge railing to be reinstalled is stored at a RIDOT maintenance facility in East Providence. The existing anchor bolts will be reused and new nuts will be required. Plans of the existing structures along with the detour plan construction documents are provided in Appendix B.

2.2. Summary of the Design-Build Proposal Process

The Best Value Design-Build Procurement process will be a one-step simultaneous process.

This RFP is now posted on the State's purchasing website soliciting Proposers to submit Technical and Cost Proposals. The qualified Proposer that presents the Best Value in the judgment of the State will be invited to enter into a contract with the State for design and construction of the Project.

Proposers should thoroughly review the definitions in Section 1.4 of this RFP.

Proposers must comply with the following, as well as the other requirements in this RFP:

- Proposers will be required to submit a description of each DB Entity's relevant experience, particularly with respect to experience similar to this Project with a particular focus on the ability to deliver such on time and on budget. Identify and describe a maximum of 10 relevant projects (limited to one [1] page) with at least two (2) projects equal to or greater than \$5 million and at least one (1) project equal to or greater than \$10 million completed in the past ten (10) years which demonstrate adequate experience in the following:

- Design-Build experience on bridge and highway projects of a similar scale and scope;
- Bridge and highway projects performed for RIDOT;
- Construction using Prefabricated Bridge Components;
- Relevant and verifiable evidence of good performance and lessons learned from previous projects and how these will benefit this project.

For each project, provide project name, owner's name, address, principal contact with current phone number and email address, dates of design/construction, construction value and description of the work involved.

- Key Personnel that it has assigned or will assign to the Project, stating the specific role that each person would perform in Project work. Those identifications will be deemed a binding commitment that if the Proposer should receive the Contract, those identified "team members" will, in fact, play the designated roles in Project design and construction. Proposers are precluded from substituting, replacing, or removing any of the Key Personnel without the written consent of the State to do so. If a Proposer believes that a substitution for any identified Key Personnel is warranted at any time (due to an intervening event), the Proposer shall so notify the State in writing, providing details of the proposed change and the reasons for it. The State shall not withhold such consent unreasonably. Proposed substitutions for such identified Personnel shall have equal or better credentials than the Personnel that they would be replacing. Should the substituted Personnel, in the opinion of the State, prove to not meet or exceed the experience and training that the original team member possessed, the Technical Review Group may reevaluate the Proposer's Qualifications score accordingly, if the substitution is proposed before award of the Contract.
- Proposers will be required to submit a price (and a schedule of values) for design and construction of the Project ("Price Proposal"), and the selected Proposer must place in escrow, as prescribed in Section 5 of this RFP, all of the documents ("Price Documents") that it used or



EAST BAY BIKE PATH BARRINGTON/WARREN

BARRINGTON/WARREN, RHODE ISLAND

Bid # 7670815

BEST VALUE DESIGN-BUILD PROCUREMENT FOR
EAST BAY BIKE PATH
REQUEST FOR PROPOSALS

PART 2
TECHNICAL PROVISIONS

ADDENDUM #3
February 3, 2022

- c. RIDOT LRFD Bridge Design Manual, Latest Edition.
- d. RIDOT Bridge Design Standard Details.
- e. Design shall be based on Load and Resistance Factor Design (LRFD) for H15-44 Live Loading and 90 psf pedestrian loading. Vehicle and pedestrian loads shall not be placed in combination.
- f. All new bridges shall be designed and constructed with a minimum design life of 30 years for the decking system and 75 years for all other components as required by AASHTO.
- g. Seismic Analysis and design shall be in accordance with AASHTO LRFD Bridge Design Specifications (AASHTO LRFD).
All of the bridges shall be classified as non-critical.
- h. AASHTO/AWS D1.5 Bridge Welding Code, 2020. No welded attachments other than cross frame connection plates are allowed to a tension area of any member.
- i. All structural steel material for girders, cross frames, and diaphragms as well as other steel details, shall be new steel conforming to AASHTO M 270 (ASTM A709) Grade 50.
- j. All reinforcing steel shall conform to AASHTO M 31, Grade 60. All reinforcing steel shall be galvanized in accordance with ASTM A767 Class 1.
- k. All steel members shall be galvanized in accordance with RIDOT Standard Specifications. The standard color shall be Federal Standard Color 25183 (Semi-Gloss).
- l. The D/B Entity shall provide structural design for all conduits and utility attachments to the steel structural members. All such design details and attachments that are not characteristic of infinite fatigue design life are not allowed.
- m. Maximum deflection due to Live Load shall be in conformance with RIDOT requirements outlined in Section 2.5 of the RIDOT LRFD Bridge Design Manual. For bridge with only pedestrian and/or bicycle traffic, the deflection limit for live load is limited by L/500. AASHTO guide specs say L/360.
- n. Bridge utilities shall be supported by the superstructure and detailed so as to be accessible for future maintenance, replacement, and/or upgrading.
- o. The D/B Entity shall design shear blocks to resist lateral seismic design loads. Only interior shear blocks shall be provided to resist seismic loads.
- p. An anti-graffiti coating is required on all exposed concrete surfaces of all bridges and walls under this contract in accordance with the Specification for Section 842 – Anti-Graffiti Coating. The coating shall be clear.
- q. The D/B Entity is required to maintain a 30' buffer between any existing substructure foundation and any material stockpile.

The D/B Entity's Final Design shall conform to the RIDOT Bridge Design Manual, with the amendments to the following Sections of the Bridge Design Manual:

Section 1.4.2 – A final design that includes one or more fracture critical members will require the submission of an ATC. All fracture critical members shall include the use of bolted members in tension areas unless it can be proven infeasible.

Section 2.3 – Bridge Structure Types - The following bridge types will not be accepted in the final design:

- a. The use of butted precast prestressed concrete box beams or voided slabs;
- b. Precast three-sided concrete structures;
- c. Cast-in-place concrete slab; and